

**Specifications**

|   |              |   |
|---|--------------|---|
| Nominal Voltage                           |              | 12 V  |
| Capacity (25°C)                           | 20HR(10.5V)  | 9Ah   |
|   | 10HR(10.5V)  | 8.4Ah   |
|   | 1HR(9.60V)   | 5.8Ah   |
| Dimension                                 | Length       | 151 ± 1.5mm (5.94inch)                                |
|   | Width        | 65 ± 1mm (2.56inch)                                   |
|   | Height       | 94 ± 1mm (3.70inch)                                   |
|   | Total Height | 100 ± 1mm (3.94inch)                                  |
| Approx. Weight                            |              | 2.50kg (5.51lbs) ± 5%                                 |
| Terminal type                             |              | T1/T2   |
| Internal resistance (Fully charged, 25°C) |              | Approx. 19mΩ  |
| Capacity affected by temperature (20HR)   | 40°C         | 102%  |
|   | 25°C         | 100%  |
|   | 0°C          | 85%   |
|   | -15°C        | 65%   |
| Self-discharge (25°C)                     | 3 month      | Remaining Capacity: 91%                               |
|   | 6 month      | Remaining Capacity: 82%                               |
|   | 12 month     | Remaining Capacity: 65%                               |
| Nominal operating temperature             |              | 25°C ± 3°C (77°F ± 5°F)                               |
| Operating temperature range               | Discharge    | -15°C ~ 50°C (5°F ~ 122°F)                            |
|   | Charge       | -10°C ~ 50°C (14°F ~ 122°F)                           |
|   | Storage      | -20°C ~ 50°C (-4°F ~ 122°F)                           |
| Float charging voltage(25°C)              |              | 13.60 to 13.80V<br>Temperature compensation: -18mV/°C |
| Cyclic charging voltage(25°C)             |              | 14.50 to 14.90V<br>Temperature compensation: -30mV/°C |
| Maximum charging current                  |              | 2.7A  |
| Terminal material                         |              | Copper  |
| Maximum discharge current                 |              | 135A(5 sec.)  |
| Designed floating life(20°C)              |              | 10years   |

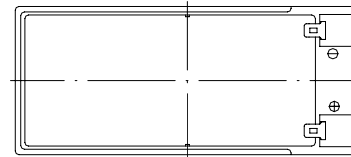

**Dimensions**

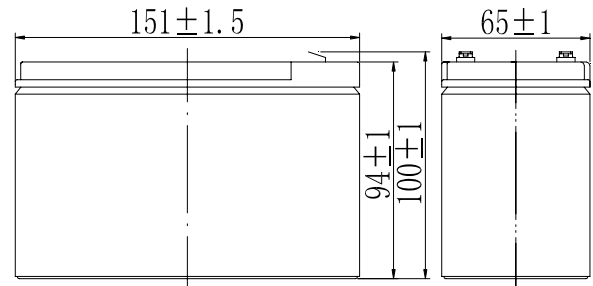

**Terminal**

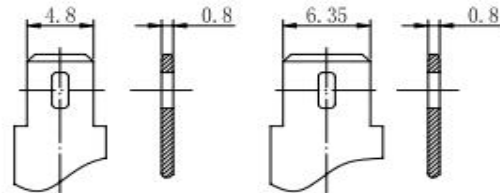

Terminal T1

Terminal T2

- ◆ Absorbent glass mat technology;
- ◆ Recognized by CE;
- ◆ ABS container.

**Constant Current Discharge Characteristics (A, 25°C)**

| F.V/TIME | 5min | 10min | 15min | 30min | 60min | 2h   | 3h   | 4h   | 5h   | 10h  | 20h  |
|----------|------|-------|-------|-------|-------|------|------|------|------|------|------|
| 9.60V    | 34.1 | 21.5  | 17.1  | 9.54  | 5.85  | 3.20 | 2.30 | 1.84 | 1.56 | 0.85 | 0.46 |
| 9.90V    | 33.2 | 21.0  | 16.7  | 9.35  | 5.76  | 3.18 | 2.28 | 1.83 | 1.55 | 0.85 | 0.45 |
| 10.2V    | 31.8 | 20.1  | 16.1  | 9.06  | 5.62  | 3.15 | 2.27 | 1.81 | 1.54 | 0.84 | 0.45 |
| 10.5V    | 30.4 | 19.2  | 15.5  | 8.84  | 5.50  | 3.10 | 2.25 | 1.80 | 1.53 | 0.84 | 0.45 |
| 10.8V    | 28.7 | 18.1  | 14.7  | 8.52  | 5.34  | 3.02 | 2.18 | 1.75 | 1.48 | 0.82 | 0.44 |

**Constant Power Discharge Characteristics (Watt, 25°C)**

| F.V/TIME | 5min | 10min | 15min | 30min | 60min | 2h   | 3h   | 4h   | 5h   | 10h  | 20h  |
|----------|------|-------|-------|-------|-------|------|------|------|------|------|------|
| 9.60V    | 380  | 243   | 195   | 109   | 67.7  | 37.4 | 27.3 | 21.9 | 18.6 | 10.2 | 5.48 |
| 9.90V    | 370  | 236   | 190   | 107   | 66.7  | 37.2 | 27.1 | 21.7 | 18.5 | 10.2 | 5.46 |
| 10.2V    | 355  | 227   | 183   | 104   | 65.0  | 36.9 | 26.9 | 21.6 | 18.4 | 10.1 | 5.43 |
| 10.5V    | 340  | 217   | 177   | 101   | 63.7  | 36.3 | 26.7 | 21.4 | 18.3 | 10.0 | 5.40 |
| 10.8V    | 321  | 205   | 168   | 97.6  | 61.8  | 35.4 | 25.9 | 20.8 | 17.7 | 9.84 | 5.29 |

Note: The above characteristics data can be obtained within three charge/discharge cycles.

Discharge Characteristics(25°C)

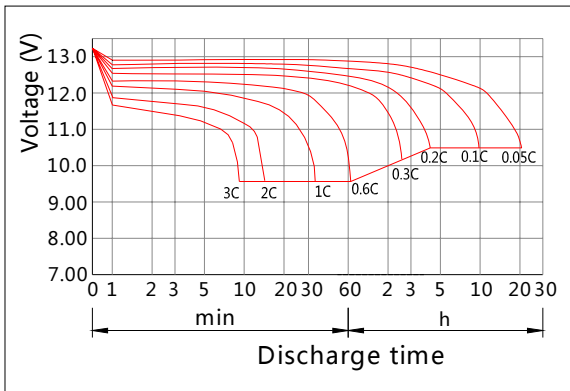

Charging Characteristics(25°C)

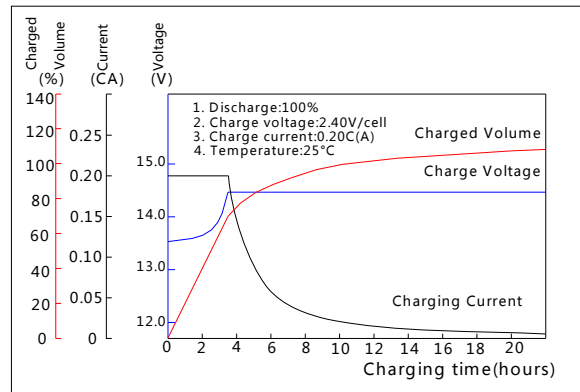

Effect of Temperature on Capacity

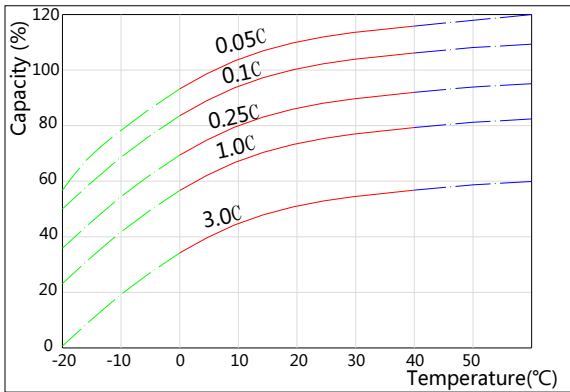

Self-discharge Characteristics

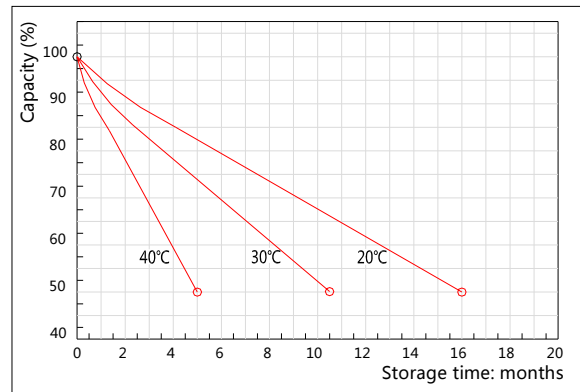

The Relationship for Open Circuit Voltage and Residual Capacity (25°C)

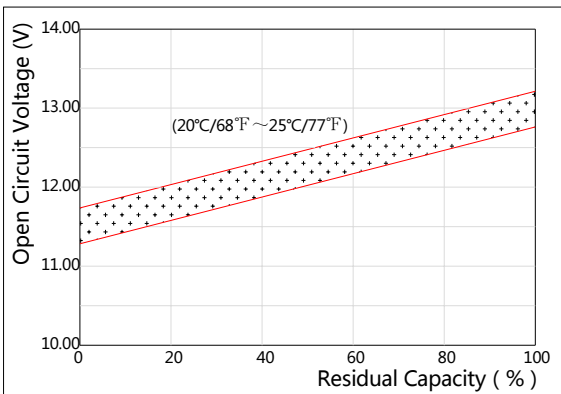

The Relationship for Charging Voltage and Temperature

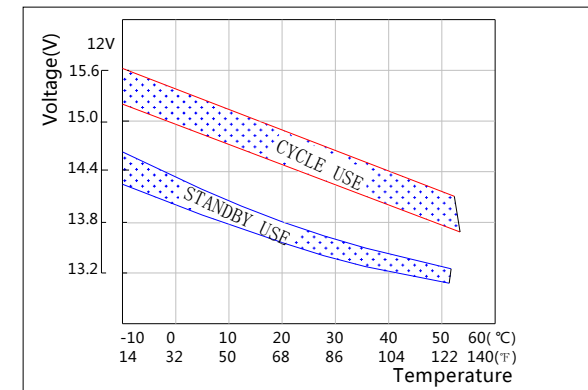

Floating Life on Temperature

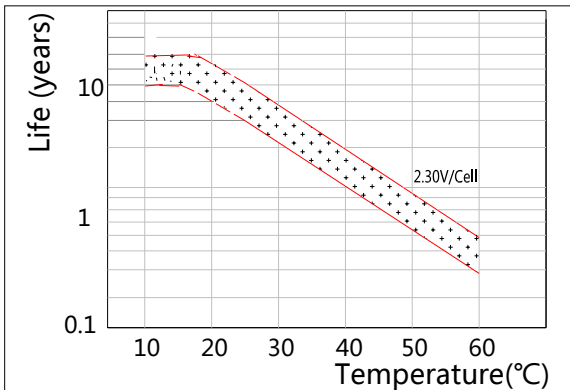

Cycle Life on D.O.D(25°C)

